



TEFLON ROTARY WASHING NOZZLES

The washing is obtained through water jets coming from a rotating head, where the head motion is assured purely by the fluid reaction forces. The rotation speed depends upon the operating pressure, which must be limited to avoid the water jets being broken into minute droplets.

REACTION DRIVE

WIL-TEFLON heads are specially designed for applications where chemical attacks from strong acid are to be expected, or when contamination to the product being handled is to be excluded, and are therefore made out of PTFE (TEFLON).

Their rotary motion is derived from the internal differential pressure of reaction forces of their water jets, which are arranged in such a way that the inner tank surface is thoroughly covered.

The simple design, a two-piece construction, assures for long, maintenance free service

Different capacities make for a range to suite many different applications

Available with NPT and BSP thread connection.

Material E1 PTFE

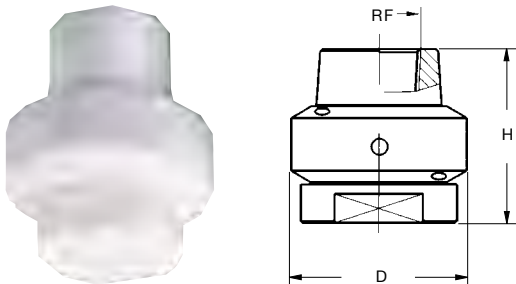

Code	RF	Flow values (lpm) (bar) at different pressures				Dimensions	
		2	3	5	7	H	D
2319 E1	1/2"	26	32	-	-	60	60
2320 E1	3/4"	26	32	-	-	60	60
3120 E1	3/4"	105	120	176	214	60	60
3198 E1	1"	158	198	274	322	64	70
A210 E1	1 1/2"	168	210	270	320	92	92